

▶ KGF-6

▶ 橋式稱重傳感器
BRIDGE LOAD CELL

▶ 材質：合金鋼 不銹鋼
Materials: Alloy Steel Stainless Steel

INTERCHANGEABLE PRODUCTS



Manufacturer _____ Mode _____

Epelsa.....STR
First Weigh.....LC32

Main Dimensions and Accessories
主要外形尺寸

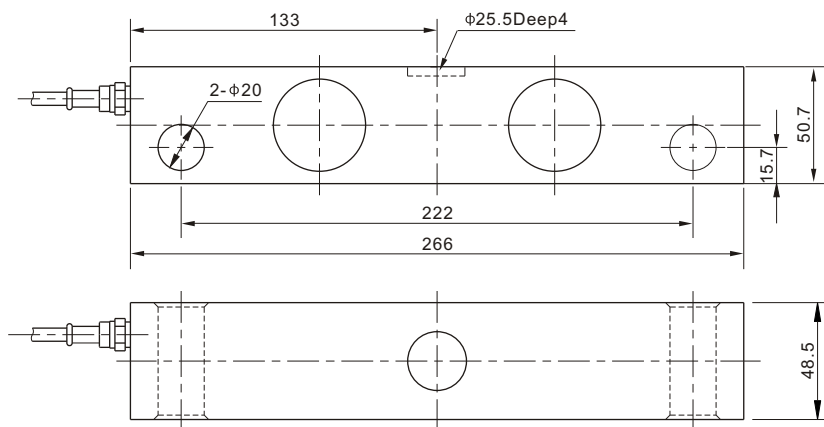

量程 **Capacity:** 40,50,65,75Klb

▶ 主要技术指标 SPECIFICATIONS

◇靈敏度Rated Output(mV/V)	3.00±0.01	◇輸入電阻Input Resistance(Ω)	700±10
◇非線性Nonlinearity	±0.03%FS	◇輸出電阻Output Resistance(Ω)	700±3
◇滯后Hysteresis	±0.03%FS	◇絕緣電阻Insulation Resistance	≥5000MΩ
◇重複性Repeatability	±0.02%FS	◇供橋電壓Excitation Voltage	10V(DC/AC)
◇蠕變Creep(30minutes)	±0.03%FS	◇溫度補償範圍Compensated Temperature Range	-10℃~+50℃
◇零點輸出Zero Balance	±1.00%FS	◇使用溫度範圍Operating Temperature Range	-20℃~+60℃
◇零點溫度系數Temperature Effect on Zero	±0.03%FS/10℃	◇允許過載負荷Safe Overload	120%FS
◇額定輸出溫度系數Temperature Effect on Output	±0.03%FS/10℃	◇連接電纜Cable	Φ6×10m

連接方法Cable Color Code

Input: Red(+) Black(-); Output: Green(+) White(-)
輸入：紅 (+) 黑 (-) ; 輸出：綠 (+) 白 (-)