

KPE-2A

稱重傳感器 LOAD CELL

材質：鋁合金 不銹鋼
Materials: Aluminum StainlessSteel

INTERCHANGEABLE PRODUCTS

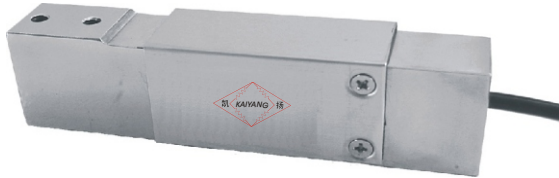

Manufacturer	Model
Rice Lake Weighing Systems.....	RL1040 RI1042
Revere Transducers.....	642
Tedea-Huntleigh.....	1040 1042
HBM.....	SP4
Celtron.....	LOC
Cotiinc.....	CI-40

Main Dimensions and Accessories
主要外形尺寸

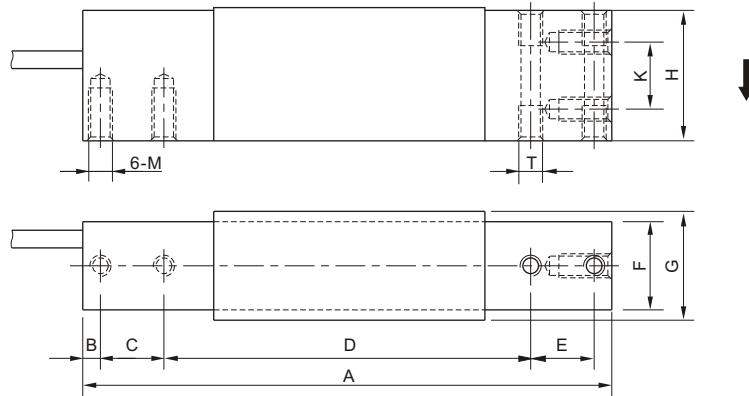

量程 Capacity kg	尺寸 Size mm										
	A	B	C	D	E	F	G	H	K	M	T
3-100	150.0	6.0	19.0	100.0	19.0	25.4	30.0	40.0	19.0	1/4-20	1/4-28

主要技術指標 SPECIFICATIONS

◇靈敏度Rated Output(mV/V)	2±0.2	◇輸入電阻Input Resistance(Ω)	410±10
◇非線性Nonlinearity	±1%FS	◇輸出電阻Output Resistance(Ω)	350±3
◇滯后Hysteresis	±1%FS	◇絕緣電阻Insulation Resistance	≥5000MΩ
◇重復性Repeatability	±0.1%FS	◇供橋電壓Excitation Voltage	10V(DC/AC)
◇蠕變Creep(30minutes)	±0.1%FS	◇溫度補償範圍Compensated Temperature Range	-10℃~+50℃
◇零點輸出Zero Balance	±1.00%FS	◇使用溫度範圍Operating Temperature Range	-20℃~+60℃
◇零點溫度系數Temperature Effect on Zero	±0.02%FS/10℃	◇允許過載負荷Safe Overload	120%FS
◇額定輸出溫度系數Temperature Effect on Output	±0.02%FS/10℃	◇連接電纜Cable	Φ5×3m

連接方法Cable Color Code

Input: Red(+) Black(-); Output: Green(+) White(-)
輸入：紅(+) 黑(-)；輸出：綠(+) 白(-)